

# Wide air gripper—HFT Series

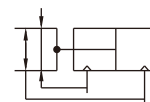

## Ordering code

**HFT 10 X 20 S T**

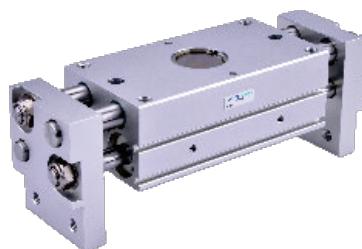
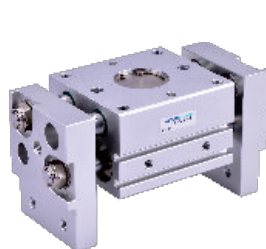

① Model	② Bore size	③ Stroke	④ Magnet	⑤ Thread type
HFT: Wide air gripper (Double acting)	10	20 30 40 60	S: With magnet	No this code
	16	30 40 60 80		
	20	40 60 80 100		
	25	40 60 80 100		
	32	60 80 100 150		T: NPT

## Specification

Bore size (mm)	10	16	20	25	32
Acting type	Double acting				
Fluid	Air(to be filtered by 40μm filter element)				
Operating pressure	35~100psi(0.25~1.05MPa)		22~100psi(0.15~1.05MPa)		
Proof pressure	175psi(1.2MPa)				
Temperature	-20~70℃				
Lubrication	Cylinder: No necessary				
Cushion type	Bumper				
Repeatability	±0.1mm				
Gripping force (N)[Note1]	14	45	74	131	228
Max. frequency	40 cycle/minute				20 cycle/minute
Port size	M5×0.8				1/8"

[Note1] Pressure 75psi and gripping length 40mm(Φ10~Φ25) or 80mm(Φ32).

Add) Refer to P481 for detail of sensor switch.

## Product feature

1. Design for large workpiece.
2. Double pistons design to increase the clamping force.
3. Magnet is included in the standard configuration.
4. The gripper opening or closing can be precisely synchronized with the rack & pinion mechanism.

# Air gripper(wide style)



## HFT Series

Bore size:  $\Phi 10$ ,  $\Phi 16$ ,  $\Phi 20$ ,  $\Phi 25$ ,  $\Phi 32$

### Dimensions

#### HFT10

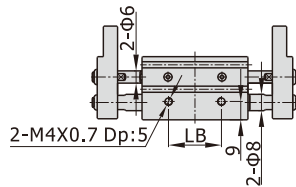
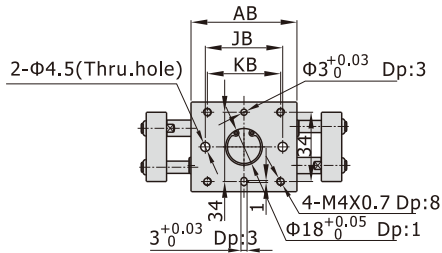
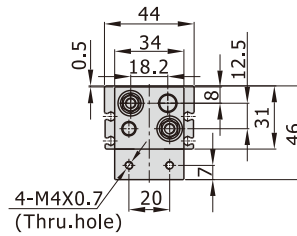
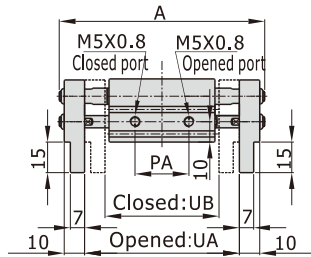

[Unit: mm]

Item/Stroke	20	30	40	60
A	101	121	141	181
AB	52	60	68	86
JB	38	46	54	72
KB	36	44	52	70
LB	26	34	42	60
PA	23	30	35	45
UA(Opened)	76	96	116	156
UB(Closed)	56	66	76	96

#### HFT16

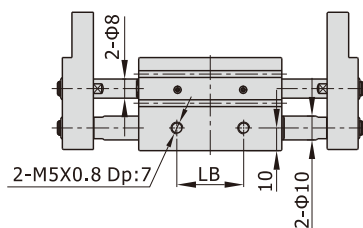
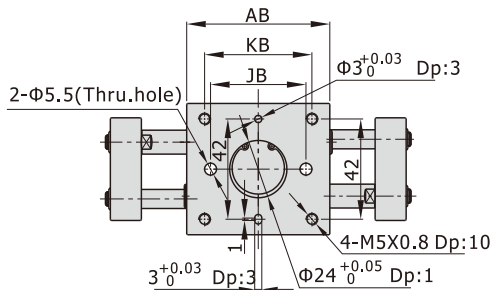
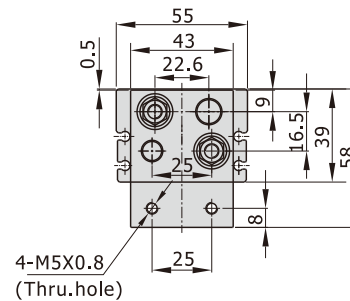
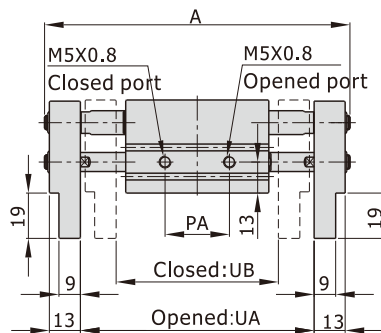

[Unit: mm]

Item/Stroke	30	40	60	80
A	128	148	194	234
AB	60	70	90	110
JB	40	50	70	90
KB	45	55	75	95
LB	28	38	58	78
PA	29	34	44	54
UA(Opened)	98	118	164	204
UB(Closed)	68	78	104	124

# Air gripper(wide style)



## HFT Series

Bore size:  $\Phi 10$ ,  $\Phi 16$ ,  $\Phi 20$ ,  $\Phi 25$ ,  $\Phi 32$

### HFT20

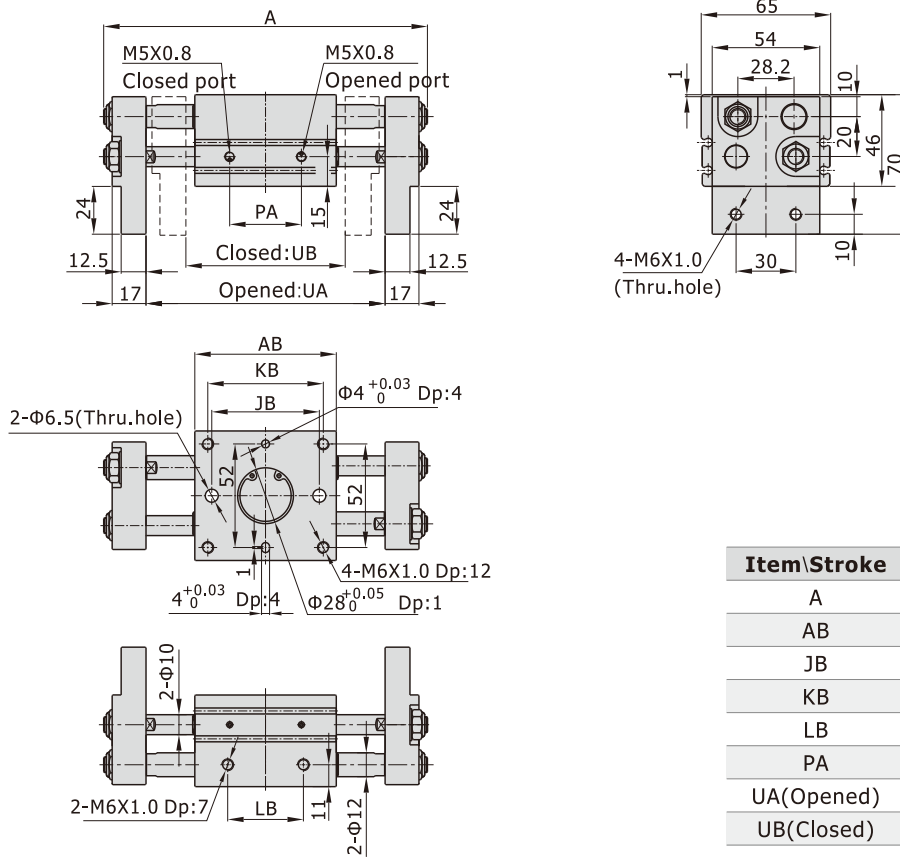

[Unit: mm]

Item\Stroke	40	60	80	100
A	163	203	255	295
AB	71	91	113	133
JB	54	74	96	116
KB	58	78	100	120
LB	38	58	80	100
PA	36	46	56	66
UA(Opened)	120	160	212	252
UB(Closed)	80	100	132	152

### HFT25

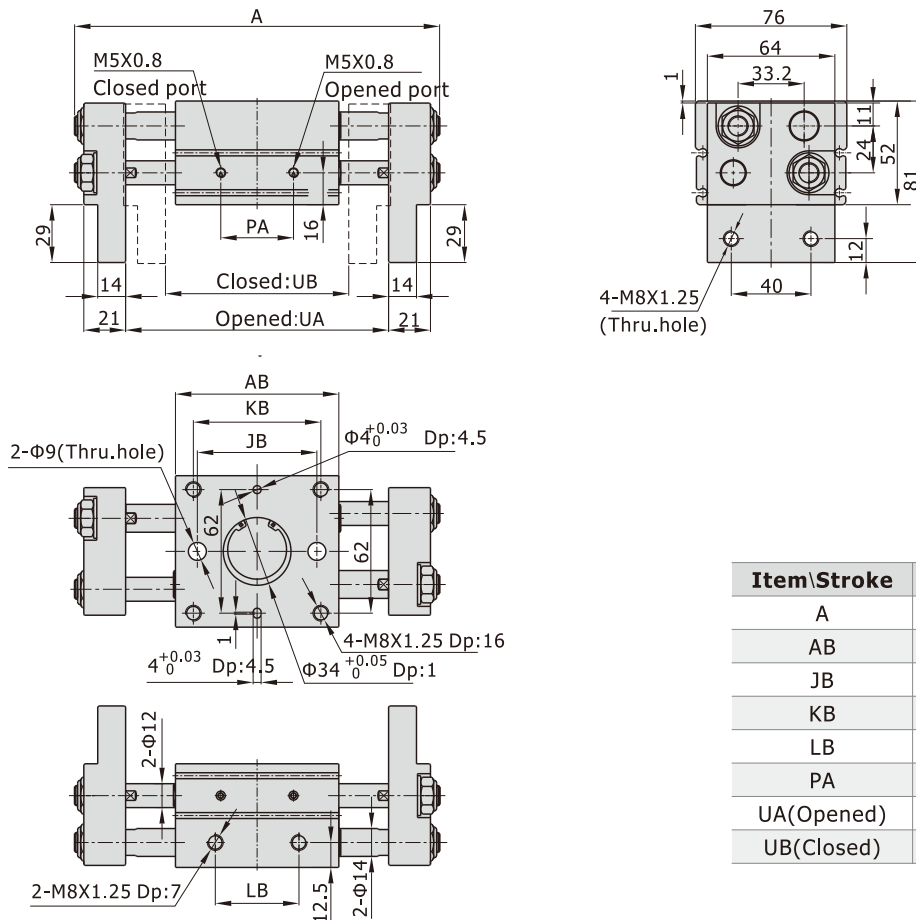

[Unit: mm]

Item\Stroke	40	60	80	100
A	183	223	277	317
AB	82	102	122	142
JB	56	66	100	120
KB	60	70	104	124
LB	38	48	82	102
PA	36.5	46.5	56.5	66.5
UA(Opened)	132	172	226	266
UB(Closed)	92	112	146	166

# Air gripper(wide style)

## HFT Series

Bore size:  $\Phi 10$ ,  $\Phi 16$ ,  $\Phi 20$ ,  $\Phi 25$ ,  $\Phi 32$

### HFT32

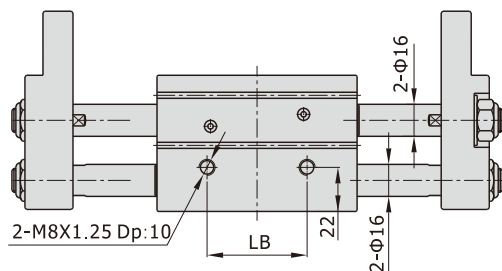
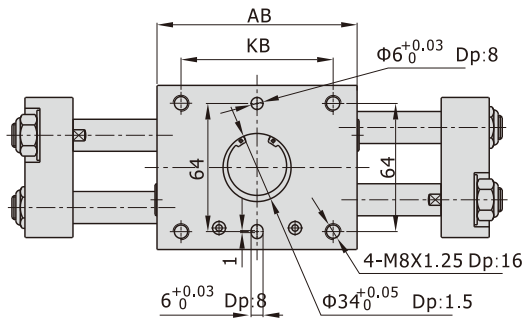
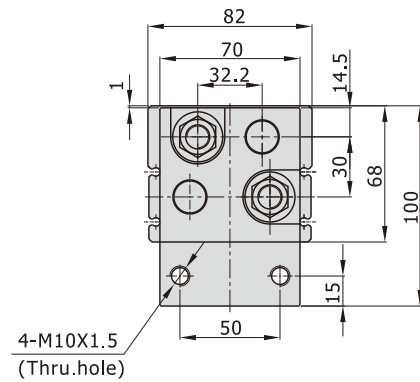
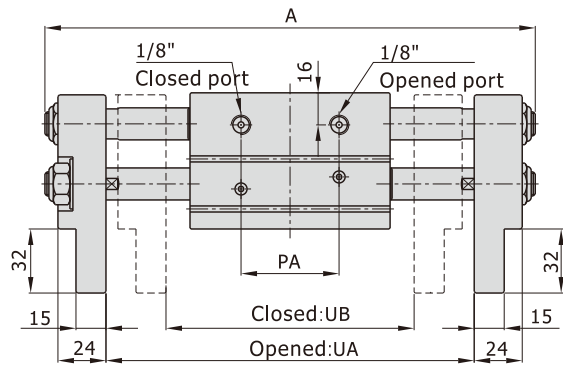

[Unit: mm]

Item\Stroke	A	AB	KB	LB	PA	UA(Opened)	UB(Closed)
60	245	100	76	50	48	184	124
80	285	120	86	60	58	224	144
100	343	158	134	108	68	282	182
150	443	208	184	158	93	382	232

### How to select product

1. Please select pneumatic finger according to the following steps:

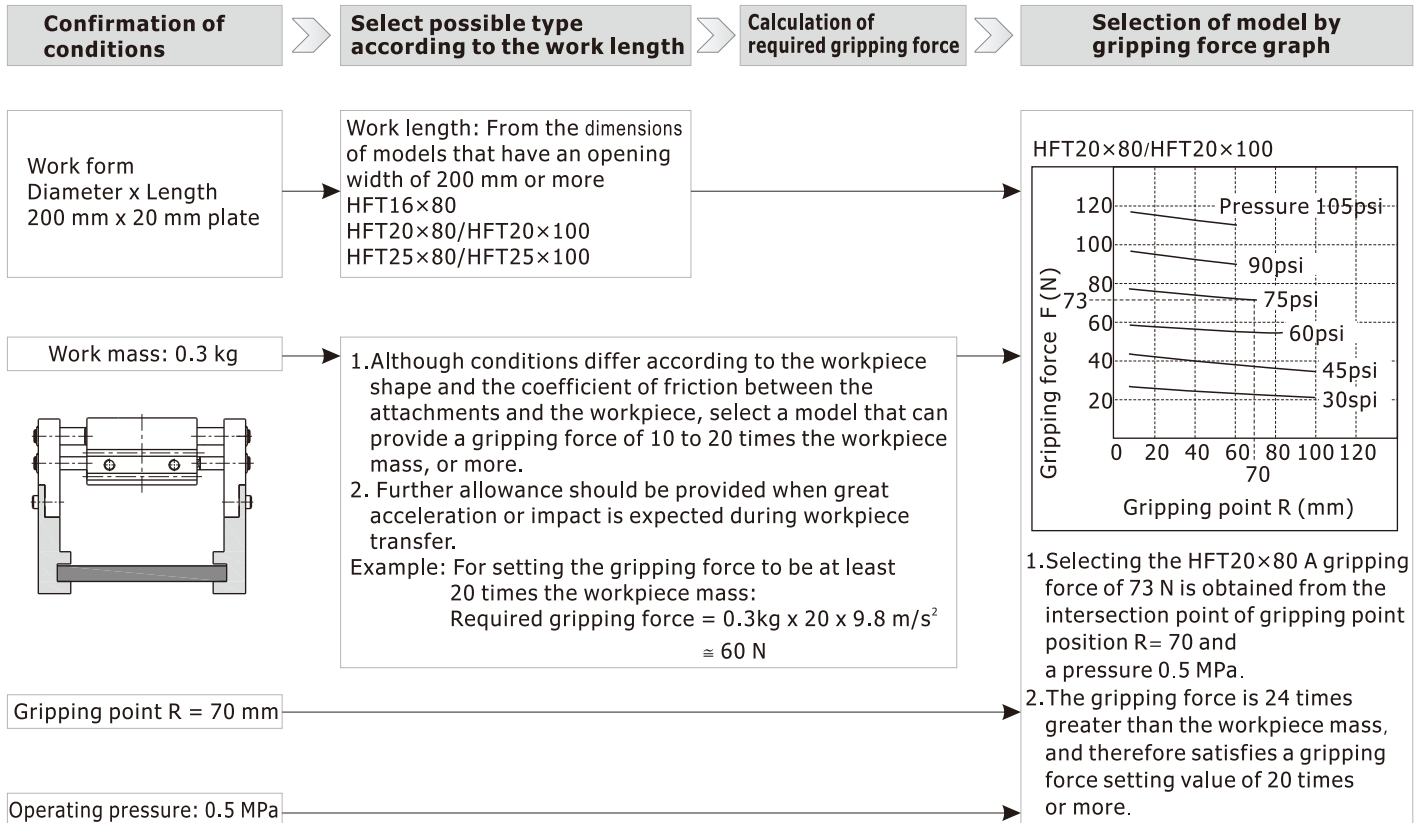

### 2. Gripping Point

- 2.1) The workpiece gripping point distance should be within the gripping force ranges given for each pressure in the effective gripping force graphs below.
- 2.2) If operated with the workpiece gripping point beyond the indicated ranges, the load that will be applied to the fingers or the guide will become excessively unbalanced. As a result, the fingers could become loosened and adversely affect the service life of the unit.

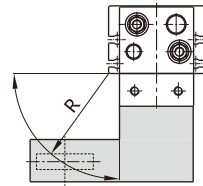
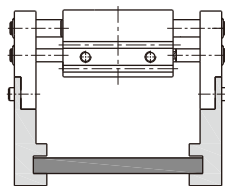

R: Gripping position (mm)

### 3. Effective Gripping Force

The gripping force shown in the tables represents the gripping force of one finger when all fingers and attachments are in contact with the work.

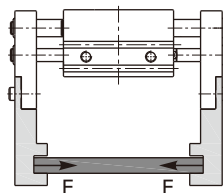

F = one finger thrust.

# Air gripper(wide style)

## HFT Series

Bore size:  $\Phi 10$ ,  $\Phi 16$ ,  $\Phi 20$ ,  $\Phi 25$ ,  $\Phi 32$

HFT10×20/HFT10×30

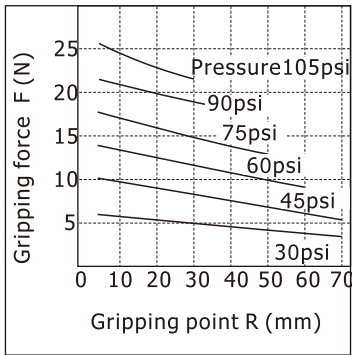

HFT10×40/HFT10×60

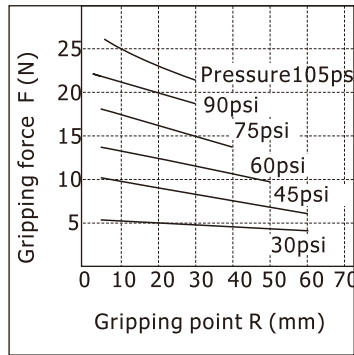

HFT16×30/HFT16×40

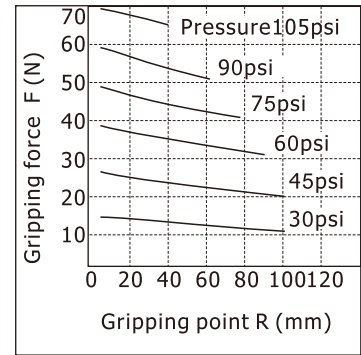

HFT16×60/HFT16×80

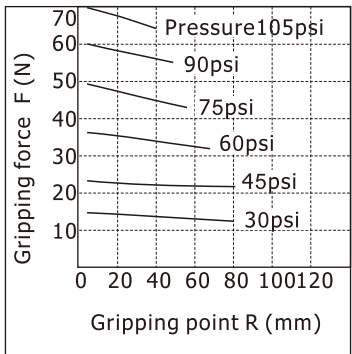

HFT20×40/HFT20×60

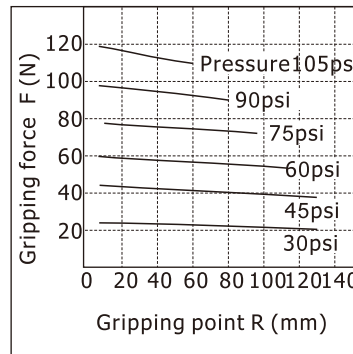

HFT20×80/HFT20×100

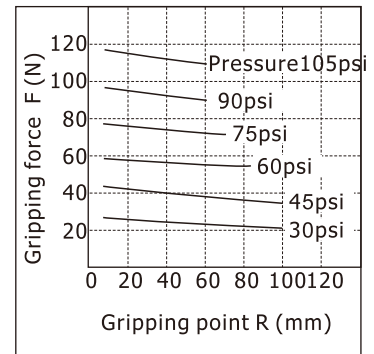

HFT25×40/HFT25×60

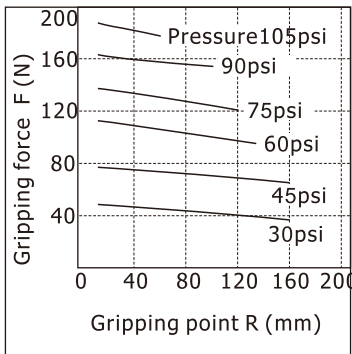

HFT25×80/HFT25×100

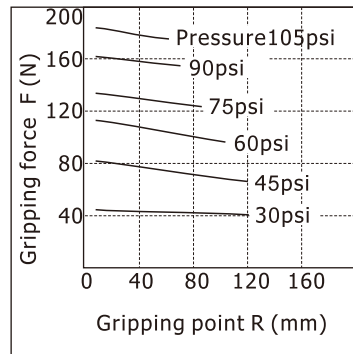

HFT32×60/HFT32×80

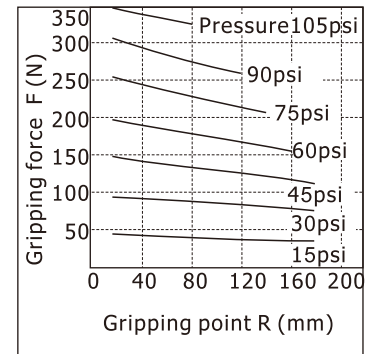

HFT32×100/HFT32×150

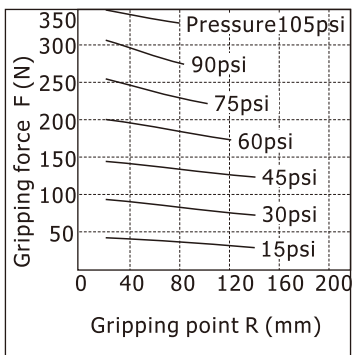

### Installation and application

1. Due to the abrupt changes, the circuit pressure is low, which will lead to the decrease of the gripping force and falling of the work-pieces. In order to avoid the harm to the human body and damage to the equipment, anti-dropping device must be equipped.
2. Don't use the air gripper under strong external force and impact force.
3. When install and fix the air gripper, avoid falling down, collision and damage.
4. When fixing the gripping jaw parts, don't twist the gripping jaw.
5. There are several kinds of installation method, and the locking torque of fastening screw must be within the prescribed torque range shown in the below chart. If the locking torque is too large, it will cause the dysfunctional. If the locking torque is too small, it will cause the position deviation and fall.

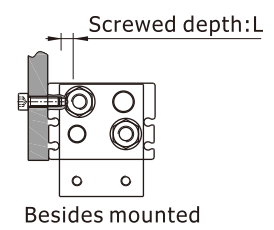
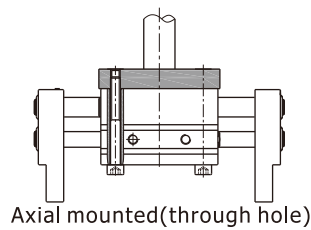
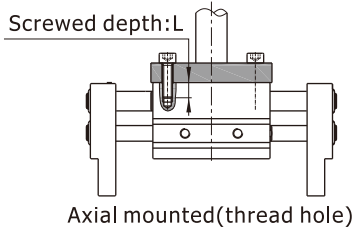

Bore size	The bolts type	Max. locking moment (Nm)	Max. screwed depth (mm)
10	M4×0.7	2.1	8
16	M5×0.8	4.3	10
20	M6×1.0	7.3	12
25	M8×1.25	17.7	16
32	M8×1.25	17.7	16

Bore size	The bolts type	Max. locking moment (Nm)
10	M4×0.7	2.1
16	M5×0.8	4.3
20	M6×1.0	7.3
25	M8×1.25	17.7
32	No Axial mounted(through hole)	

Bore size	The bolts type	Max. locking moment (Nm)	Max. screwed depth (mm)
10	M4×0.7	1.4	5
16	M5×0.8	2.8	7
20	M6×1.0	4.8	7
25	M8×1.25	12	7
32	M8×1.25	12	10

6. The installation method of the gripping jaw fittings  
When install the gripping jaw fittings, you have to pay particular attention that you can only hold the gripping jaw by using spanner, and then lock the screws with allen wrench. Never clamp the body directly and then lock the screws, otherwise the parts will be easily damaged.

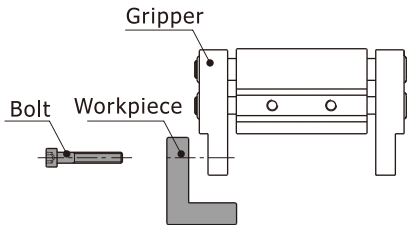

Bore size	The bolts type	Max. locking moment(Nm)
10	M4×0.7	1.4
16	M5×0.8	2.8
20	M6×1.0	4.8
25	M8×1.25	12
32	M10×1.5	24

7. Confirm that there is no external forces exerted on the gripping jaw.  
Transverse load acts on the gripping jaw, which will cause impact load and leads to the shaking and damage of gripping jaw. Equip with gaps so that the air gripper will not crash into work-pieces and accessories at the end of its trip.

#### 7.1) The end of stroke under the open state of air gripper

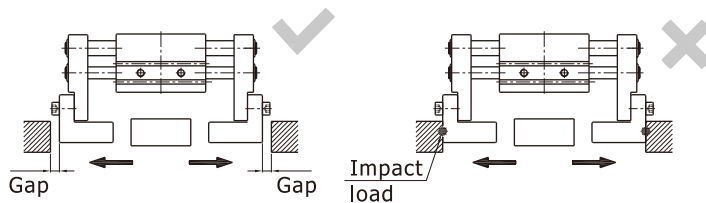

#### 7.2) The end of stroke under the move state of air gripper

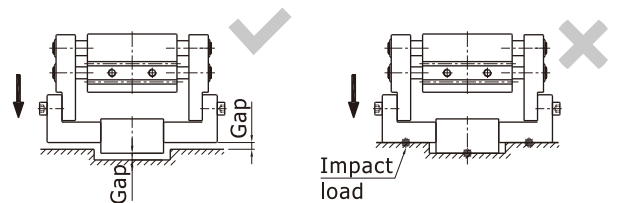

8. When the work-pieces are inserted, the center line should be coaxial, no offset, in case there are external force generated on gripping jaw. When testing, it is specially required that the manual operation should be reduced, the pressure should be used to run it at a low speed, and guarantee the safety and no impact.

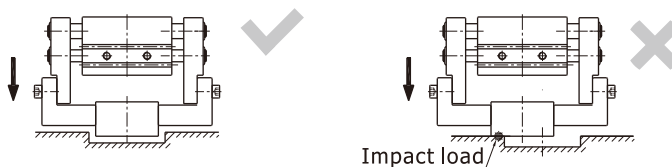

9. Please use the flow control valve to adjust the opening and closing speed of gripping jaw if too fast.
10. People can not enter the movement path of air gripper and articles can not be placed on the path too.
11. Before removing the air gripper, please confirm that it is out of working state, and then discharge of compressed air.